

---

INSTRUCTION BOOK

**TERMALINE<sup>®</sup> LOAD RESISTOR  
SEMICONDUCTOR  
SERIES 8890SC**



**Bird**  
Electronic Corporation  
Cleveland (Solon) Ohio USA

---

©Copyright 2002 by Bird Electronic Corporation  
Instruction Book Part Number 920-8890-SEMICON

Rev. A

Termaline<sup>®</sup> and Tenuline<sup>®</sup> are Registered Trademarks  
of Bird Electronic Corporation



## Safety Precautions

---

The following are general safety precautions that are not necessarily related to any specific part or procedure and do not necessarily appear elsewhere in this publication. These precautions must be thoroughly understood and apply to all phases of operation and maintenance.

### ***Keep Away From Live Circuits***

Operating personnel must at all times observe normal safety regulations. Do not replace components or make adjustments inside the equipment with high voltage turned on. To avoid casualties, always remove power.

### ***Shock Hazard***

Do not attempt to remove the RF transmission line while RF power is present.

### ***Do Not Service or Adjust Alone***

Under no circumstances should any person reach into an enclosure for the purpose of service or adjustment of equipment except in the presence of someone who is capable of rendering aid.

### ***Safety Earth Ground***

An uninterruptible earth safety ground must be supplied from the main power source to test instruments. Grounding one conductor of a two conductor power cable is not sufficient protection. Serious injury or death can occur if this grounding is not properly supplied.

### ***Chemical Hazard***

Dry cleaning solvents for cleaning parts may be potentially dangerous. Avoid inhalation of fumes or prolonged contact with skin.

### ***Resuscitation***

Personnel working with or near high voltages should be familiar with modern methods of resuscitation.

## Safety Symbols

### WARNING

Warning notes call attention to a procedure which, if not correctly performed, could result in personal injury.

### CAUTION

Caution notes call attention to a procedure which, if not correctly performed, could result in damage to the instrument.



This symbol indicates that a shock hazard exists if the precautions in the instruction manual are not followed.



The caution symbol appears on the equipment indicating there is important information in the instruction manual regarding that particular area.



This symbol indicates that the unit radiates heat and should not be touched while hot.

☞ NOTE: Calls attention to supplemental information.

## Warning Statements

The following safety warnings appear in the text where there is danger to operating and maintenance personnel and are repeated here for emphasis.

### WARNING

The vent plug must be used at all times when the unit is operating or cooling. Failure to do so could result in an explosion or severe burns.

### WARNING

Never attempt to connect or disconnect RF equipment from the transmission line while RF power is being applied.  
Leaking RF energy is a potential health hazard.

### WARNING

Disconnect the unit from all power sources before servicing.  
The unit may be energized from multiple sources.  
The potential for electric shock exists.

### **Caution Statements**

The following equipment cautions appear in the text whenever the equipment is in danger of damage and is repeated here for emphasis.

#### **CAUTION**

The Bird 8890-300SC13 is not designed for use with a blower. Do not install a blower on the unit. Doing so will void the warranty.

#### **CAUTION**

This load is designed for operation in a horizontal position only, with the vent plug up. Do not use in any other manner.

#### **CAUTION**

If installed, connect optional interlock before applying RF power.

#### **CAUTION**

Use only Bird coolant, P/N 5-1070, to prevent damage to the load.

## **Safety Statements**

### USAGE



ANY USE OF THIS INSTRUMENT IN A MANNER NOT SPECIFIED BY THE MANUFACTURER MAY IMPAIR THE INSTRUMENT'S SAFETY PROTECTION.

### USO

EL USO DE ESTE INSTRUMENTO DE MANERA NO ESPECIFICADA POR EL FABRICANTE, PUEDE ANULAR LA PROTECCIÓN DE SEGURIDAD DEL INSTRUMENTO.

### BENUTZUNG

WIRD DAS GERÄT AUF ANDERE WEISE VERWENDET ALS VOM HERSTELLER BESCHRIEBEN, KANN DIE GERÄTESICHERHEIT BEEINTRÄCHTIGT WERDEN.

### UTILISATION

TOUTE UTILISATION DE CET INSTRUMENT QUI N'EST PAS EXPLICITEMENT PRÉVUE PAR LE FABRICANT PEUT ENDOMMAGER LE DISPOSITIF DE PROTECTION DE L'INSTRUMENT.

### IMPIEGO

QUALORA QUESTO STRUMENTO VENISSE UTILIZZATO IN MODO DIVERSO DA COME SPECIFICATO DAL PRODUTTORE LA PROZIONE DI SICUREZZA POTREBBE VENIRNE COMPROMESSA.

### SERVICE



SERVICING INSTRUCTIONS ARE FOR USE BY SERVICE - TRAINED PERSONNEL ONLY. TO AVOID DANGEROUS ELECTRIC SHOCK, DO NOT PERFORM ANY SERVICING UNLESS QUALIFIED TO DO SO.

### SERVICIO

LAS INSTRUCCIONES DE SERVICIO SON PARA USO EXCLUSIVO DEL PERSONAL DE SERVICIO CAPACITADO. PARA EVITAR EL PELIGRO DE DESCARGAS ELÉCTRICAS, NO REALICE NINGÚN SERVICIO A MENOS QUE ESTÉ CAPACITADO PARA HACERLO.

### WARTUNG

ANWEISUNGEN FÜR DIE WARTUNG DES GERÄTES GELTEN NUR FÜR GESCHULTES FACHPERSONAL.

ZUR VERMEIDUNG GEFÄHRLICHER, ELEKTRISCHER SCHÜSSE,  
SIND WARTUNGSARBEITEN AUSSCHLIEßLICH VON  
QUALIFIZIERTEM SERVICEPERSONAL DURCHFÜHREN.

#### ENTRETIEN

L'EMPLOI DES INSTRUCTIONS D'ENTRETIEN DOIT ÊTRE  
RÉSERVÉ AU PERSONNEL FORMÉ AUX OPÉRATIONS  
D'ENTRETIEN. POUR PRÉVENIR UN CHOC ÉLECTRIQUE  
DANGEREUX, NE PAS EFFECTUER D'ENTRETIEN SI L'ON N'A PAS  
ÉTÉ QUALIFIÉ POUR CE FAIRE.

#### ASSISTENZA TECNICA

LE ISTRUZIONI RELATIVE ALL'ASSISTENZA SONO PREVISTE  
ESCLUSIVAMENTE PER IL PERSONALE OPPORTUNAMENTE  
ADDESTRATO. PER EVITARE PERICOLOSE SCOSSE ELETTRICHE  
NON EFFETTUARE ALCUNA RIPARAZIONE A MENO CHE  
QUALIFICATI A FARLA.



CONNECT INTERLOCK TO TRANSMITTER/GENERATOR/  
AMPLIFIER BEFORE OPERATING.

BRANCHER LE VERROUILLAGE À L'ÉMETTEUR/  
GÉNÉRATEUR/AMPLIFICATEUR AVANT EMPLOI.

CONECTE EL INTERBLOQUEO AL TRANSMISOR/GENERADOR/  
AMPLIFICADOR ANTES DE LA OPERACION.

VOR INBETRIEBNAHME VERRIEGELUNG AM SENDER/  
GENERATOR/VERSTÄRKER ANSCHLIESSEN.

PRIMA DI METTERE IN FUNZIONE L'APPARECCHIO, COLLEGARE  
IL DISPOSITIVO DI BLOCCO AL TRASMETTITORE/GENERATORE/  
AMPLIFICATORE.

## About This Manual

---

This instruction book covers the models listed below:

8890-300SC13

This instruction book is arranged so that essential information on safety is in the front of the book. Reading the Safety Precautions before operating the equipment is strongly advised. The remainder of this instruction book is divided into Chapters and Sections.

### ***Operation***

First time operators should read Chapter 1 – Introduction, and Chapter 3 – Installation, to get an overview of equipment capabilities and how to install it. An experienced operator can refer to Chapter 4 – Operating Instructions. All instructions necessary to operate the equipment are contained in this section.

### ***Maintenance***

All personnel should be familiar with preventative maintenance found in Chapter 5 – Maintenance. If a failure should occur, the troubleshooting section will aid in isolating and repairing the failure. Parts lists and repair instructions are also in this chapter.

### ***Changes***

We have made every effort to ensure this manual is accurate at the time of publication. If you should discover any errors or if you have suggestions for improving this manual, please send your comment to our factory. This manual may be periodically updated. When inquiring about updates to this manual, refer to the part number and revision level on the title page.



## Table of Contents

---

<b>Safety Precautions</b> . . . . .	<b>i</b>
<b>About This Manual.</b> . . . . .	<b>.vi</b>
<b>Introduction</b> . . . . .	<b>1</b>
Items Supplied . . . . .	1
Items Required but not Supplied. . . . .	1
Optional Accessories. . . . .	1
<b>Theory of Operation</b> . . . . .	<b>3</b>
Load Resistor . . . . .	3
Coolant . . . . .	3
Thermal Interlock . . . . .	3
<b>Installation</b> . . . . .	<b>5</b>
Unpacking and Inspection. . . . .	5
Setup. . . . .	5
Mounting . . . . .	5
Installing Thermoswitch. . . . .	6
Interlock Connection . . . . .	7
Connecting RF Power. . . . .	8
<b>Operating Instructions</b> . . . . .	<b>9</b>
Normal Operation . . . . .	9
Operation Under Abnormal Conditions . . . . .	9
Shutdown . . . . .	9
Emergency Shutdown . . . . .	9
<b>Maintenance</b> . . . . .	<b>11</b>
Troubleshooting . . . . .	11
Maintenance . . . . .	12
Cleaning . . . . .	12
Inspection . . . . .	12
DC Resistance . . . . .	12
Coolant Level . . . . .	13

Repair . . . . .	14
RF Connector . . . . .	14
Load Resistor . . . . .	14
Storage and Shipment . . . . .	15
Customer Service . . . . .	15
Specifications . . . . .	16
Replacement Parts . . . . .	17
Available “QC” Type Connectors . . . . .	17

Bird 8890 Series Semiconductor loads are portable, 50 ohm, coaxial RF transmission line terminations. They are designed for frequency ranges of dc – 28 MHz, specially calibrated for greater stability at 13.56 MHz. They provide accurate, dependable, and low reflection line terminations. Up to 2500 watts of RF power can be dissipated.

The load has a coolant chamber surrounded by radiator fins. The front and rear fins form mounting flanges which can be used as supports for freestanding use or as brackets for fixed mounting. A vent plug at the top of the unit relieves internal pressure from coolant expansion. The load's simple and rugged design minimizes maintenance requirements.

**CAUTION**

The Bird 8890-300SC13 is not designed for use with a blower. Do not install a blower on the unit. Doing so will void the warranty.

**Items Supplied**

- Load Resistor: Pre-filled with coolant at the factory
- Shipping Plug
- Vent Plug
- Instruction Manual

**Items Required but  
not Supplied**

- Coupling Kit: Connects the load to the RF line

**Optional  
Accessories**

- Interlock Thermoswitch: Automatically shuts off the RF generator to prevent overheating of the load

Figure 1  
Bird 8890 Series  
Outline Drawing

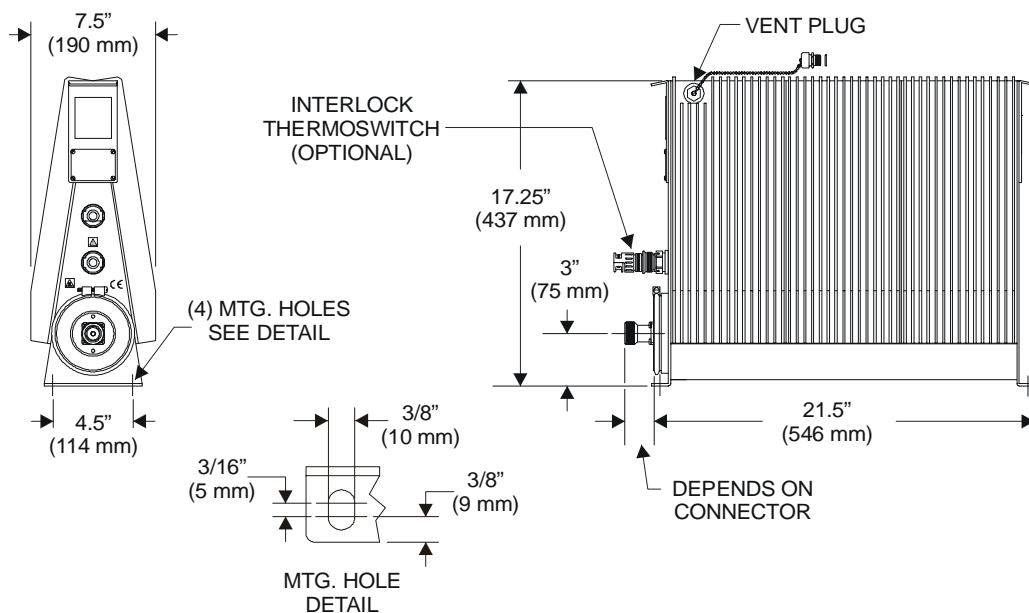

- Load Resistor** Bird 8890 loads consist of a thin-film-on-ceramic resistor immersed in a dielectric coolant. The resistor, individually selected for its accuracy, is enclosed in a special housing. When surrounded by the coolant, this produces a uniform, practically reflectionless line termination over the specified frequencies.
- Coolant** The load is cooled by natural fluid and air convection currents. The coolant, chosen for its dielectric and thermal characteristics, carries heat from the resistor to the walls of the cooling tank, where radiator fins surrounding the tank transfer the heat to the air.
- When the coolant is heated, thermal expansion causes an increase in the internal pressure. The vent plug relieves this pressure while protecting the opening from dirt or other contaminants.
- Thermal Interlock** The load can be supplied with an optional passive overtemperature thermoswitch. Normally closed, it opens at the maximum safe load temperature of 236 °C (457 °F), turning off power to the RF generator. The interlock system will not permit reoperation of the generator until the load has reached a lower, safe temperature.

*Figure 2*  
*Shipping Plug*

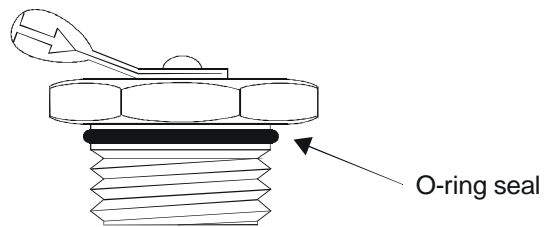

*Figure 3*  
*Vent Plug*

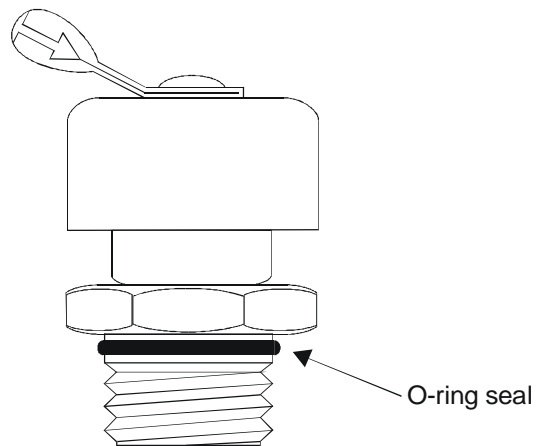

This chapter provides information for on-site requirements, unpacking, inspection, and preparing the load for use.

**CAUTION**

The Bird 8890-300SC13 is not designed for use with a blower. Do not install a blower on the unit. Doing so will void the warranty.

**Unpacking and Inspection**

1. Carefully inspect the shipping container for signs of damage. If damage is noticed, do not unpack the unit. Immediately notify the shipping carrier and Bird Electronic Corporation.
2. If the container is not damaged, unpack the unit. Save the packing materials in case the unit should need to be shipped again.
3. Inspect all of the components for visible signs of damage. Immediately notify the shipping carrier and Bird Electronic Corporation of equipment damage or missing parts.

**Setup**

- Before first using the load, get a resistance baseline for future maintenance. Refer to “DC Resistance” on page 12 for details.
- Remove the shipping plug from the load and replace it with the vent plug. Refer to Figure 2 and Figure 3 for pictures of the plugs.

**WARNING**

The vent plug must be used at all times when the unit is operating or cooling. Failure to do so could result in an explosion or severe burns.

**Mounting**

Place the load in a dry, dust and vibration free environment. Do not use outdoors or in areas of condensing humidity. Allow at least 12" (30 cm) of clearance on all sides of the load.

**CAUTION**

This load is designed for operation in a horizontal position only, with the vent plug up. Do not use in any other manner.

These loads are equipped for either portable use or fixed installation. The mounting brackets on the front and rear faces have four mounting slots arranged in a  $4\frac{1}{2}" \times 20\frac{23}{32}"$  rectangle (114.3 x 526.3 mm). Use a screw with a  $\frac{3}{8}"$  (9.53 mm) diameter max.

**Installing  
Thermoswitch**

Bird 8890 series loads can be equipped with an optional interlock thermoswitch, P/N 8890-008. It is normally closed, opening at 236 °C (457 °F), with a rating of 10A @ 120Vac and 5A @ 230Vac.

**WARNING**

The vent plug must be used at all times when the unit is operating or cooling. Failure to do so could result in an explosion or severe burns.

To install or replace a thermoswitch, follow these instructions:

1. Remove the vent plug and install the shipping plug.
2. Stand the unit on its back with the connector end up. In this position there is no danger of the coolant pouring out through the socket plug hole.
3. Remove the socket plug just above the connector assembly with a  $\frac{9}{16}$ " hex wrench.
4. Replace the plug with the thermoswitch. Sparingly apply pipe sealing compound to the external threads, only, of the thermoswitch. Do not contaminate the coolant with pipe sealant.
5. Check for coolant leaks upon completion.



**Interlock  
Connection**

Connect the thermoswitch to the interlock as follows (see Figure 4):

**CAUTION**

If installed, connect optional interlock before applying RF power.

1. Unscrew the large knurled ring-nut (A) at the lower end of the coupling jack assembly. Pull it off the thermoswitch jack (B). Unscrew the small knurled cover fitting from the base plug (D) of the connector to release the base.  
☞ NOTE: The ring-nut (A) must be in place over the base plug (D) with the knurled end facing out.
2. Thread the control switch wires through the clamp (E) with the washers (F) inside and with its threaded fitting in place. Service the control switch wire with short tips and put spaghetti sleeves over the wire ends if necessary.
3. Securely solder the control switch leads to the lugs (G) of the connector base.
4. Screw on the cover ring, then fasten the cable clamp (E) in place and tighten both yoke screws (H).
5. Put the plug back on the thermoswitch and tighten the nut (A).

*Figure 4  
Thermoswitch  
Assembly*

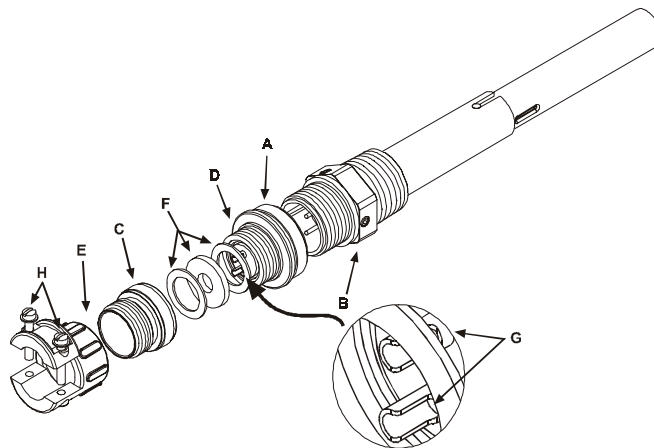

**Connecting RF  
Power**

After installing the load, the RF transmission line can be attached using standard coaxial line coupling kits.

**WARNING**

Never attempt to connect or disconnect RF equipment from the transmission line while RF power is being applied.  
Leaking RF energy is a potential health hazard.

**“QC” Connector Coupling:** Use 50 ohm coaxial cable such as RG-218/U or -220/U (-17A or -19A), appropriate for the frequency and power level of operation. Use a cable connector which will mate with the one on the load.

<b>Normal Operation</b>	Bird 8890 series loads have no indicators or operating controls. They require no special operating procedures or surveillance when their performance limits are not exceeded. Follow the instructions for the specific generator equipment.
<b>Operation Under Abnormal Conditions</b>	The load can be subjected to moderate overloads for short periods. If this is likely, make sure the interlock is properly connected to prevent damage to the load.
<b>Shutdown</b>	These loads are passive devices, so have no way of being turned off. Turn off RF power at the source.

**WARNING**

Never attempt to connect or disconnect RF equipment from the transmission line while RF power is being applied.  
Leaking RF energy is a potential health hazard.

<b>Emergency Shutdown</b>	Turn off RF power at the source.  If the interlock thermoswitch is properly connected, RF power will be automatically turned off when the coolant temperature reaches an unsafe level.
---------------------------	--



This chapter covers cleaning, inspection, trouble-shooting, and specifications for the Bird 8890 series loads.

**WARNING**

Never attempt to connect or disconnect RF equipment from the transmission line while RF power is being applied.  
Leaking RF energy is a potential health hazard.

**Troubleshooting**

The table below contains troubleshooting information for problems which can occur during normal operation. This manual cannot list all malfunctions that may occur, or their corrective actions. If a problem is not listed or is not corrected by the listed actions, notify a qualified service center.

<b>PROBLEM</b>	<b>POSSIBLE CAUSE</b>	<b>CORRECTION</b>
Leaking coolant	Loose clamping band	Tighten the clamping band
	Defective or improperly installed O-ring	Replace the O-ring (See "Load Resistor" on page 14)
High or low dc resistance	Loose RF input connector	Tighten connector
	Faulty RF input connector	Replace connector (See "RF Connector" on page 14)
	Faulty resistor	Replace the resistor (See "Load Resistor" on page 14)
Overheating radiator	RF power too high	Lower RF power (See "Specifications" on page 16 for maximum RF power)
	Coolant level too low	Check the coolant level. Add coolant if necessary (See "Coolant Level" on page 13)
	Coolant degraded	Replace the coolant (See "Coolant Level" on page 13)
	Faulty resistor	Replace the resistor (See "Load Resistor" on page 14)

## Maintenance

- Cleaning** Wipe the load free of dust and dirt when necessary. Excessive dust on the cooling fins will interfere with heat dissipation. Clean the RF connector, both metallic and insulating surfaces, with a dry, non-residue forming solvent.
- Inspection** Inspect the unit every six months. Check for coolant leakage around the clamping band and the thermoswitch. Also check for corrosion.
- DC Resistance** Measuring the dc resistance between the inner and outer conductors of the RF connector shows changes in the load over time, a good check of the load resistor's condition. Under normal operating conditions, the resistor should provide at least 5,000 hours of operation before requiring any additional service. DC resistance tracking must start before the load is put into service, and should be measured annually.

Perform the following steps and record the value for future comparison. Make sure that you have an ohmmeter with an accuracy of  $\pm 1\%$  at 50 ohms and that the load temperature is between 20 and 25 °C (68 to 77 °F) before starting.

*Figure 5  
Measuring  
Resistance*

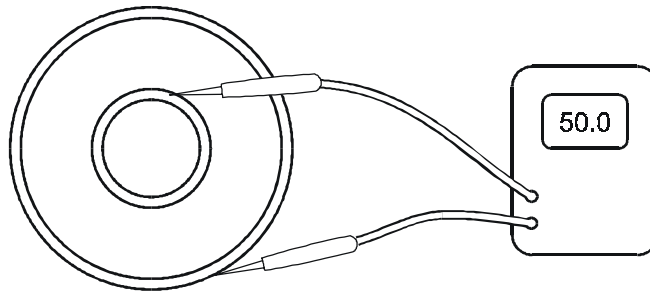

**WARNING**

Never attempt to connect or disconnect RF equipment from the transmission line while RF power is being applied.  
Leaking RF energy is a potential health hazard.

1. Turn off the RF power and interlock circuitry.
2. Disconnect the RF line.
3. Connect the multimeter test leads to the center and outer conductor of the load resistor. Refer to Figure 5.
4. Compare the measured value with the previous measurement and with the baseline resistance, measured when the load was put into service. If the new value differs from either of these by more than 1 ohm this could indicate a failing resistor.

**Coolant Level**

Coolant lifetime will vary greatly depending on the operating temperature. For heavy use (full RF power for long times, high ambient temperature, 50 Hz ac supply), check the coolant every 500 hours. If the load has only had light duty (fraction of full power, low ambient temperature, 60 Hz ac supply), then coolant inspection may only be necessary every 2,000 hours.

☞ **NOTE:** Correct any coolant leakage before inspection. (See “Troubleshooting” on page 11)

**WARNING**

Disconnect the unit from all power sources before servicing.  
The unit may be energized from multiple sources.  
The potential for electric shock exists.

To inspect the coolant:

- Remove the load resistor (Refer to “Load Resistor” on page 18).

**CAUTION**

Use only Bird coolant, P/N 5-1070, to prevent damage to the load.

- The coolant should be clear, with a faint yellow tinge, and have a slightly sweet smell. If it is black with a burnt or acrid smell, drain it and add about 2.9 gal (11 L) of coolant.
- With the load still on end, the coolant level should be  $4\frac{3}{4}$  to 5 inches (125 mm) below the top surface of the resistor assembly mounting ring, at ambient temperature. Add coolant if necessary.

## Repair

### WARNING

Disconnect the unit from all power sources before servicing.  
The unit may be energized from multiple sources.  
The potential for electric shock exists.

### CAUTION

The Bird 8890-300SC13 is not designed for use with a blower. Do not install a blower on the unit. Doing so will void the warranty.

#### RF Connector

The Bird 8890-300SC13 has a Bird “QC” connector which allows easy changing of the RF connector. This does not disturb the coolant seal or affect the electrical continuity of the load. To change the connector:

- Remove the four screws at the corners of the RF connector.
- Pull the connector straight out.
- Push the new connector in. Make sure that the center pin on the connector is properly seated in the mating socket on the load.
- Replace the screws.

☞ NOTE: If not using the LC connector normally supplied, the frequency and power must be limited to the capabilities of the connector.

#### Load Resistor

To change the load resistor assembly:

1. Remove the vent plug and install the shipping plug.
2. Stand the unit on its back with the connector end up. In this position there is no danger of the coolant pouring out through the socket plug hole.
3. Unscrew and remove the clamping band.
4. Lift the load resistor assembly out of the tank and allow any coolant to drip back into the tank.
5. Check the O-Ring. It should be free of twists and positioned evenly around the flange of the resistor housing. If the O-ring shows signs of deterioration (e.g. is no longer pliable or has surface cracks) replace it.



6. Replace the entire load resistor assembly. It cannot be further disassembled.
7. Put the clamping band in place and tighten it.
8. Remove the shipping plug and install the vent plug.

## Storage and Shipment

Cover the load before storing to keep out dust and dirt. It is not necessary to install the shipping plug. Store in a dry, dust-free environment where the ambient temperature will remain between  $-40$  and  $+45$  °C ( $-40$  to  $+113$  °F).

To ship the load, take the following precautions:

- Remove the vent plug and replace it with the shipping plug. Wrap the vent plug with padding and tape it to the side of the load for protection.
- ☞ NOTE: With the shipping plug installed, it is not necessary to empty out the coolant.
- Wrap the connector in padding.
  - Pack and brace the load in a sturdy wooden crate for shipment.

## Customer Service

Any maintenance or service procedure beyond the scope of those in this chapter should be referred to a qualified service center.

If you need to return the unit for any reason, contact the Bird Service Center for a return authorization. All instruments returned must be shipped prepaid and to the attention of Bird Service Center.

### **Bird Service Center**

30303 Aurora Road  
Cleveland (Solon), OH 44139-2794  
Phone: (440) 519-2298  
Fax: (440) 519-2326

For the location of the Sales Office nearest you, give us a call or visit our Web site at:

*<http://www.bird-electronic.com>*

## Specifications

<b>Frequency Range</b>	dc – 28 MHz
<b>Power Rating</b>	2500 W continuous duty
<b>Impedance, Nominal</b>	50 ohms
<b>VSWR</b>	1.1 max
<b>VSWR Stability</b>	< 0.1 dB, from 0 to 100% rated power at stability frequency
<b>Stability Frequency</b>	13.56 MHz $\pm$ 10 kHz
<b>Connectors</b>	“QC” Type, Female LC normally supplied
<b>Interlock Thermoswitch (Optional)</b>	Normally closed. Opens at 236 °C (457 °F)
<b>Thermoswitch Rating</b>	
115 Vac	10 A
230 Vac	5 A
<b>Temperature, Operating</b>	+5 to +40 °C (+41 to +104 °F)
<b>Temperature, Storage</b>	–40 to +45 °C (–40 to +113 °F)
<b>Altitude*</b>	1520 m (5000 ft.)
<b>Humidity</b>	95% noncondensing max
<b>Cooling method</b>	Oil dielectric and convection currents
<b>Dimensions</b>	21.75" L x 7.5" W x 17.25" H (551 x 190 x 437 mm)
<b>Weight, Nominal</b>	59 lb. (27 kg)
<b>Finish</b>	Black Epoxy Resin

\* Derate RF power by 2.5% for every 305m (1,000 ft.) above 1,520m (5,000 ft.).

## Replacement Parts

DESCRIPTION	QTY	PART NUMBER
RF Load Resistor	1	8890-060
Resistor O-Ring	1	5-230
Clamping band assembly	1	2430-055
Plug Vent Shipping	1	2450-094 2450-049
Overtemp thermoswitch	1	8890-008
Thermoswitch body	1	8890-005
Thermoswitch jack	1	2450-018
Coolant, 2.9 gal (11 liters)	1	5-1070
Radiator assembly	1	2450-313
Access plug 3/4"-14 hex socket	2	5020-103

## Available “QC” Type Connectors

Connector	Part Number	Connector	Part Number	Connector	Part Number
BNC-Female	4240-125	LT-Female	4240-018	Mini UHF-Female	4240-346
BNC-Male	4240-132	LT-Male	4240-012	UHF-Female	4240-050
C-Female	4240-100	N-Female	4240-062	UHF-Male	4240-179
C-Male	4240-110	N-Male	4240-063	1-5/8" EIA Fixed	4240-096
HN-Female	4240-268	SC-Female	4240-090	1-5/8" EIA Swivel	4240-208
HN-Male	4240-278	SMA-Female	4240-336	7/8" EIA	4240-002
LC-Female *	4240-031	SMA-Male	4240-334	TNC-Female	4240-156
LC-Male	4240-025	7/16 Jack, IEC Type 169-4	4240-344	TNC-Male	4240-160
Open Term. # 10-32 Nut	4240-080	7/16 Plug, IEC Type 169-4	4240-363		

\* Normally supplied

## **Limited Warranty**

All products manufactured by Seller are warranted to be free from defects in material and workmanship for a period of one (1) year, unless otherwise specified, from date of shipment and to conform to applicable specifications, drawings, blueprints and/or samples. Seller's sole obligation under these warranties shall be to issue credit, repair or replace any item or part thereof which is proved to be other than as warranted; no allowance shall be made for any labor charges of Buyer for replacement of parts, adjustment or repairs, or any other work, unless such charges are authorized in advance by Seller.

If Seller's products are claimed to be defective in material or workmanship or not to conform to specifications, drawings, blueprints and/or samples, Seller shall, upon prompt notice thereof, either examine the products where they are located or issue shipping instructions for return to Seller (transportation-charges prepaid by Buyer). In the event any of our products are proved to be other than as warranted, transportation costs (cheapest way) to and from Seller's plant, will be borne by Seller and reimbursement or credit will be made for amounts so expended by Buyer. Every such claim for breach of these warranties shall be deemed to be waived by Buyer unless made in writing within ten (10) days from the date of discovery of the defect.

The above warranties shall not extend to any products or parts thereof which have been subjected to any misuse or neglect, damaged by accident, rendered defective by reason of improper installation or by the performance of repairs or alterations outside of our plant, and shall not apply to any goods or parts thereof furnished by Buyer or acquired from others at Buyer's request and/or to Buyer's specifications. Routine (regularly required) calibration is not covered under this limited warranty. In addition, Seller's warranties do not extend to the failure of tubes, transistors, fuses and batteries, or to other equipment and parts manufactured by others except to the extent of the original manufacturer's warranty to Seller.

The obligations under the foregoing warranties are limited to the precise terms thereof. These warranties provide exclusive remedies, expressly in lieu of all other remedies including claims for special or consequential damages. SELLER NEITHER MAKES NOR ASSUMES ANY OTHER WARRANTY WHATSOEVER, WHETHER EXPRESS, STATUTORY, OR IMPLIED, INCLUDING WARRANTIES OF MERCHANTABILITY AND FITNESS, AND NO PERSON IS AUTHORIZED TO ASSUME FOR SELLER ANY OBLIGATION OR LIABILITY NOT STRICTLY IN ACCORDANCE WITH THE FOREGOING.

# DECLARATION OF CONFORMITY

Manufacturer: Bird Electronic Corporation  
30303 Aurora Road  
Cleveland, Ohio 44139-2794

Product: Termaline Load Resistor

Models: 8890-300SC13

The undersigned hereby declares, on behalf of Bird Electronic Corporation of Cleveland, Ohio, that the above referenced products, to which this declaration relates, are in conformance with the provisions of the following standards.

- European Standard 61326-1:1997 – Electronic Equipment for Measurement, Control and Laboratory Use – EMC Requirements

These standards are in accordance with EMC Directive (89/336/EEC).

- European Standard EN 61010-1:1993 – Safety Requirements for Electrical Equipment for Measurement, Control, and Laboratory Use: Including Amendment 2: 1995

This standard is in accordance with Low Voltage Directive (73/23/EEC), 1973 Including Amendment (93/68/EEC), 1993

The technical documentation supporting compliance with these directives is maintained at Bird Electronic Corporation, 30303 Aurora Road, Cleveland, Ohio 44139



Bob Gardiner  
Director of Quality  
Bird Electronic Corporation